

P-10333

MAP NO. U16	GRID REF	WELL NUMBER 840/10 Soak	PHOTOS
WELL DEPTH NK (shown as deep soak bore0	Measured/Reported	Well Diameter (mm) 75mm	
Yield M3/day or L/min		Well Driller KA Carpenter Ltd	
Drilling Date 19/08/1977	Well Type – Production / Re-injection / DHE / Coil / Other Soak Bore		
Owner Mr Barnard	Address 16B Otonga Road		
Source of information on location / log / etc RDC site visit		RDC Permit No. 643 + Bore users data 1989 + RDC Property file	
REMARKS	LOCATION MAP		
Deep soak bore can be up to 50mt deep			

840/10

FILE 658 12151

CITY OF ROTORUA



APPLICATION FOR "A" GEOTHERMAL DISPOSAL BORE PERMIT
"B" GEOTHERMAL SHALLOW SOAK BORE PERMIT

I hereby apply for a permit to construct a geothermal disposal bore in accordance with the City of Rotorua Geothermal Energy Bylaw 1973 on the property situated at:

ADDRESS

LOT NO 41 D.P.S. SECTION BLOCK

OWNER MR BARNARD ADDRESS 16 OTONGA ROAD

TYPE OF HOLE:	DIAMETER:	DEPTH:	WITH LINERS
	3"		WITHOUT LINERS

DEEP SOAK BORE BATH OVER FLOW BLOW DOWN HOLE FOR BORE

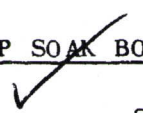

SITE PLAN SHOWING EXACT LOCATION OF HOLE OR BORE

OTONGA ROAD

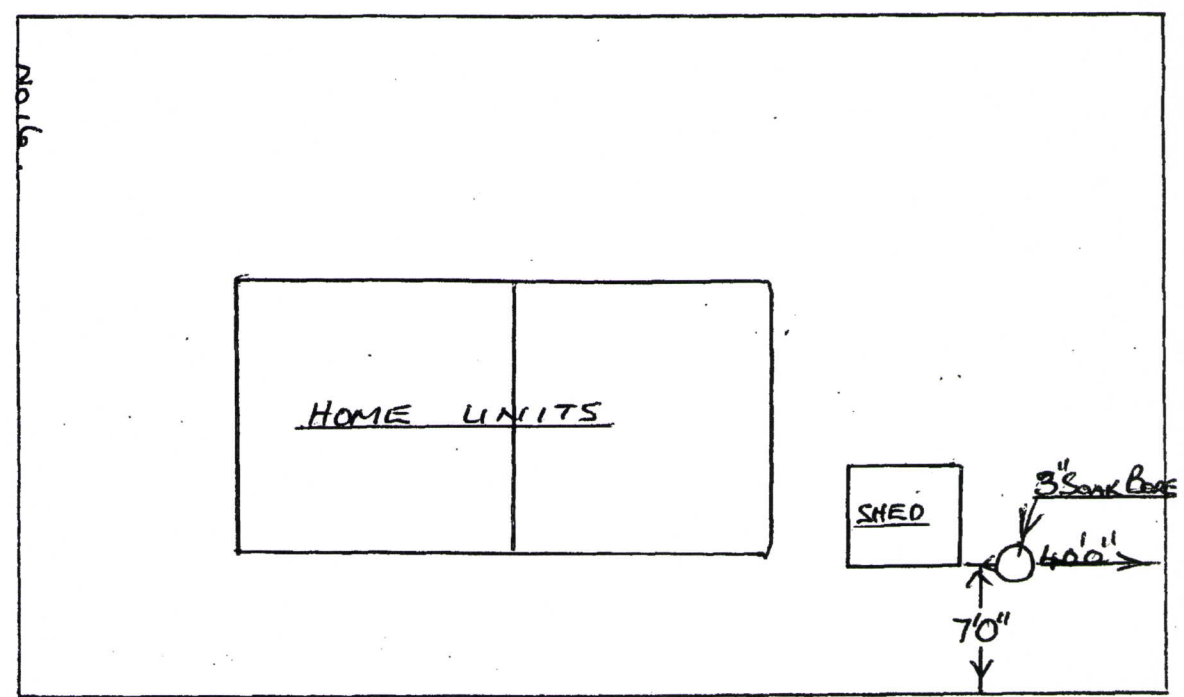

FOR OFFICE USE ONLY

APPROVED: [Signature] DATE: 19-8-77 PERMIT NO: 643 RECEIPT NO: 21522

FEE:	Application Fee	\$5.00	(Deep Soak Bore only)
	Water Use Fee	\$2.00	
		\$7.00	

Shallow Drilled Soakholes - \$1.50 ea.

Completed and OK.

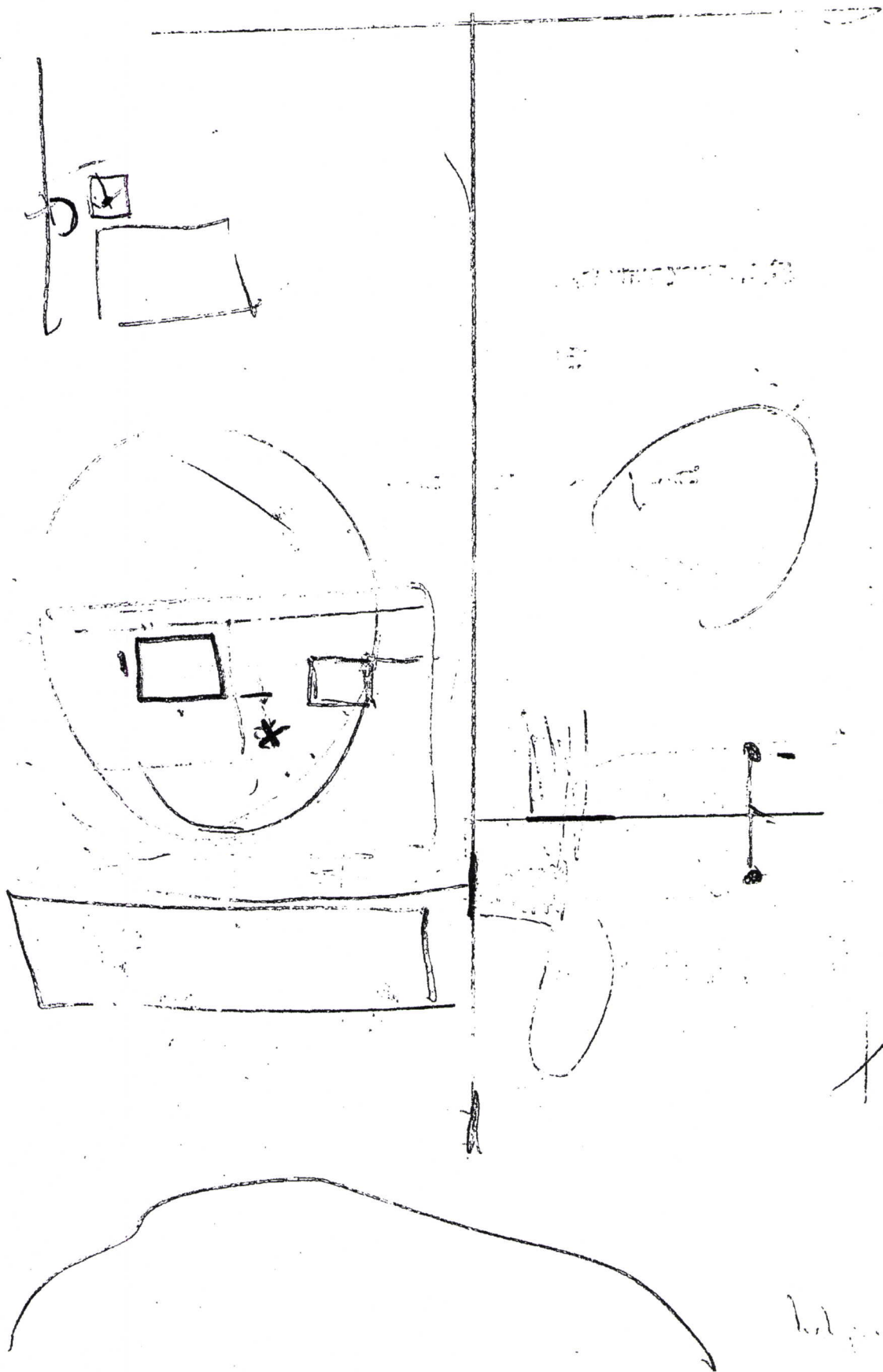

GEOHERMAL SITE PLAN

HARRIS HEATING SERVICES
VIEW ROAD, ROTORUA
Phone 79-493

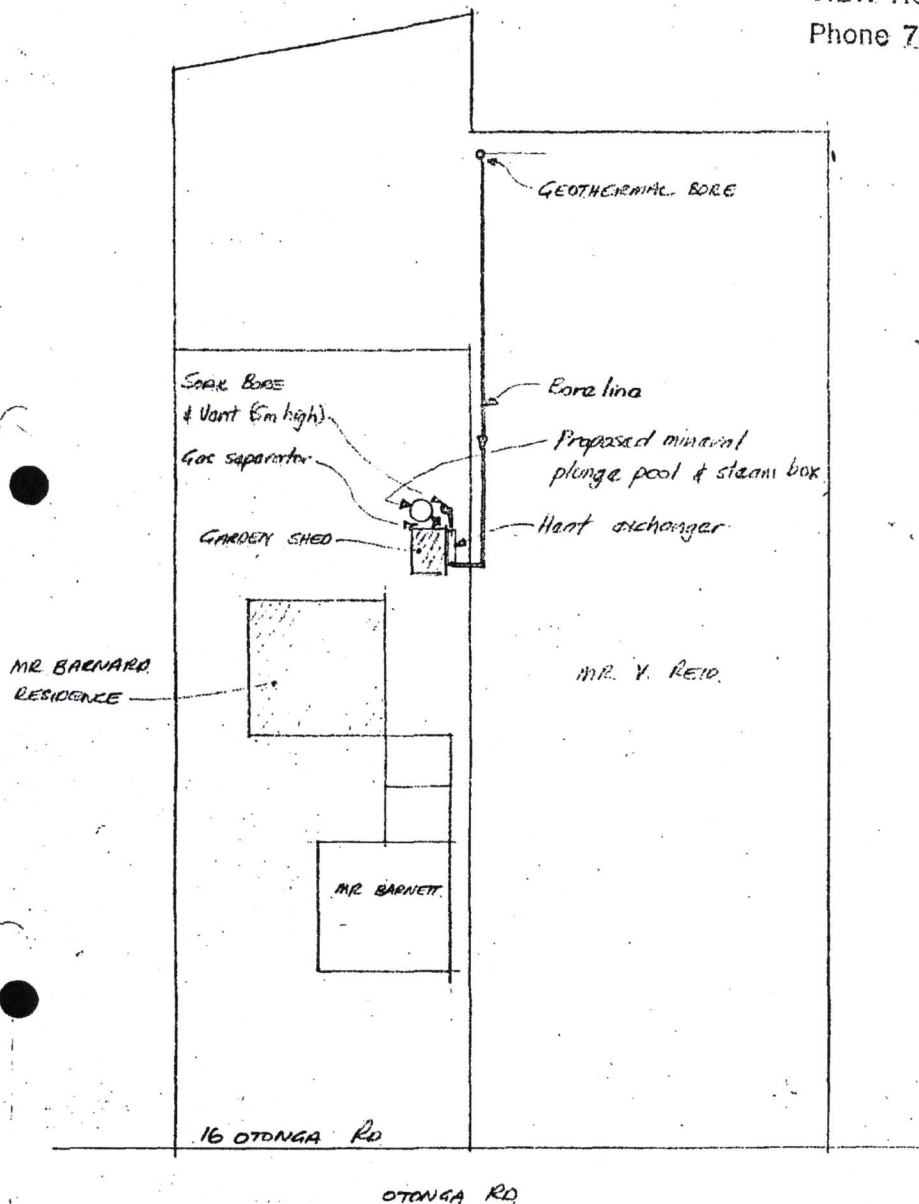

(NOT TO SCALE)

Indicate in plan form in the space above the location of the following geothermal works and structures on the property:

- (i) Main building, accessory buildings, mineral pools or baths;
- (ii) Production bore;
- (iii) Disposal bore or soak hole;
- (iv) Reticulation lines, effluent lines and heat exchangers;
- (v) Gas separation units, check valves etc.;
- (vi) Position and heights of atmospheric vents.

GEOTHERMAL SITE PLAN

HARRIS HEATING SERVICES
VIEW ROAD, ROTORUA
Phone 79-493

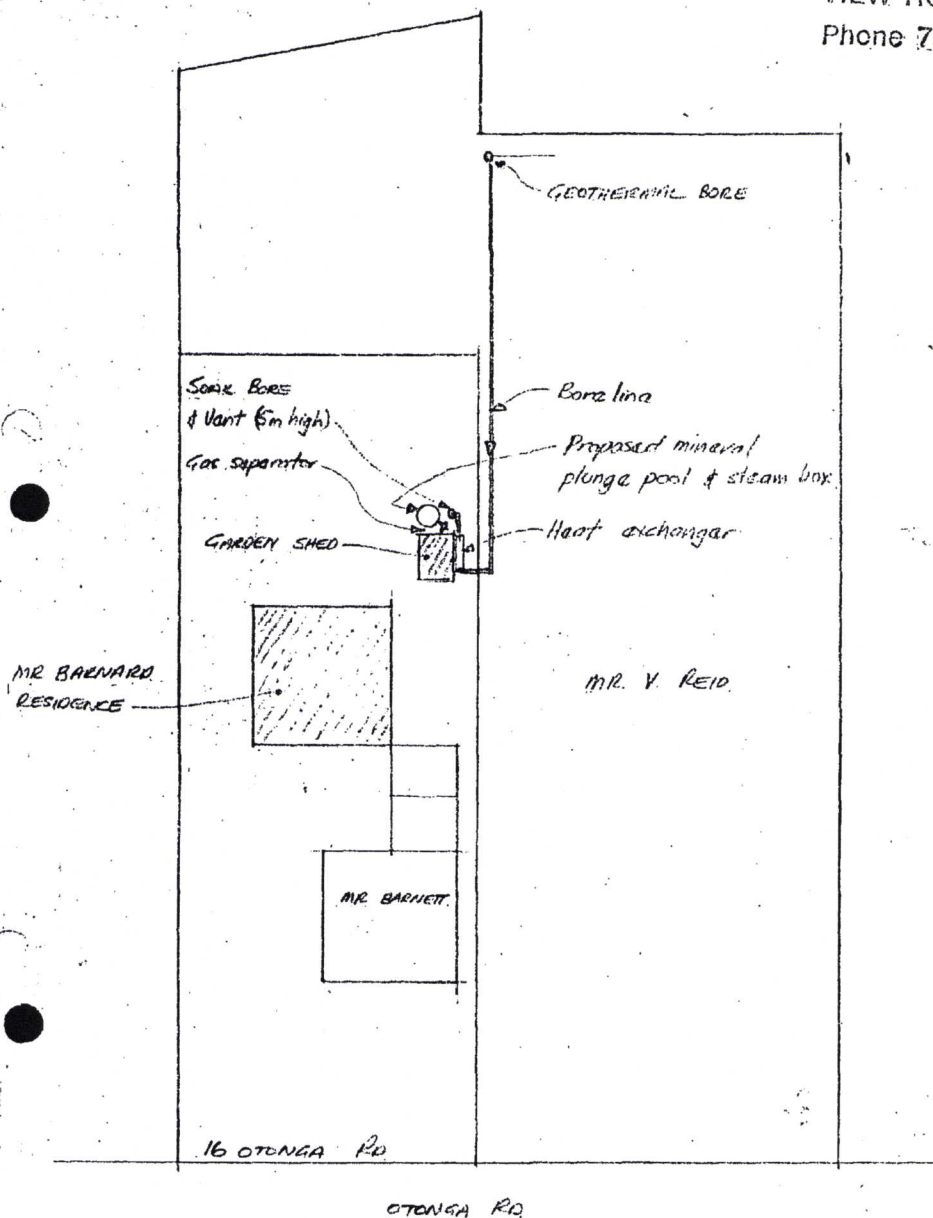

(NOT TO SCALE)

Indicate in plan form in the space above the location of the following geothermal works and structures on the property:

- (i) Main building, accessory buildings, mineral pools or baths;
- (ii) Production bore;
- (iii) Disposal bore or soak hole;
- (iv) Reticulation lines, effluent lines and heat exchangers;
- (v) Gas separation units, check valves etc.;
- (vi) Position and heights of atmospheric vents.